

**CONCRETE COVER (OPTIONAL)**  
1" = 1'-0"

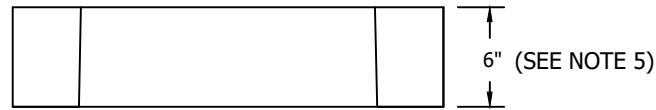

**RISER**  
1" = 1'-0"

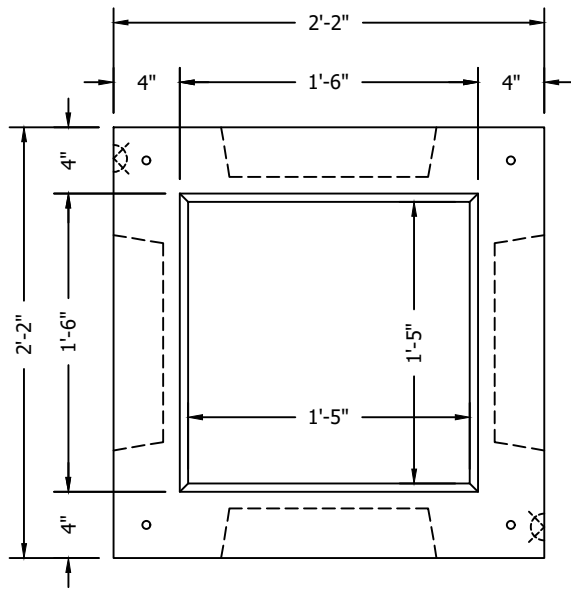

**PLAN**  
1" = 1'-0"

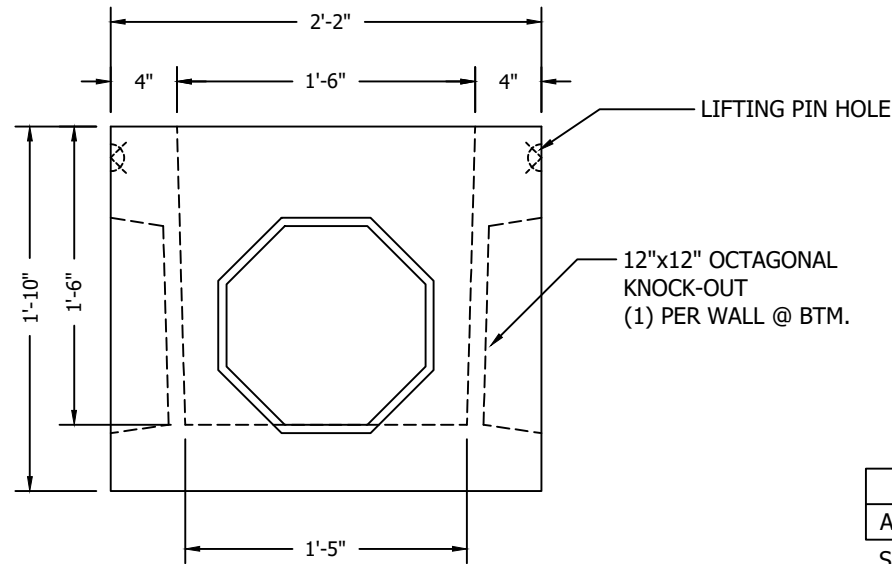

**ELEVATION**  
1" = 1'-0"

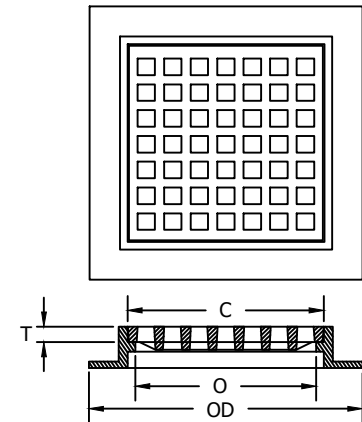

MODEL	C	O	OD	H	T
ASQ18183SH	18X18	16X16	22½X22½	3	1

SEE NOTES

**FRAME & GRATE**  
1" = 1'-0"

**NOTES:**

- 1) CONCRETE TO TEST 5,000 PSI AT 28 DAYS.
- 2) REINFORCING STEEL PER ASTM A615, #4 REBAR.
- 3) LOAD RATING: FOR A.A.S.H.T.O. & HS 20-44 HIGHWAY LOADING.
- 4) ALTERNATE FRAME AND COVER/GRATE PATTERNS AVAILABLE UPON REQUEST.
- 5) RISER HEIGHT OPTIONS INCLUDE 6" (SHOWN), 12", 18" AND 24".

**WEIGHT**  
**790 POUNDS**



276 Clove Road  
Salisbury Mills, New York, 12577  
www.arconcrete.com  
845-562-0640

18" x 18" KNOCK-OUT CATCH BASIN

CONTRACTOR:

---

DATE: 2/12/2021

REV.: ---

DWN.BY: A&R LLC

DWG. NO.: 18X18KOCB